

Vernier Calipers 16 N, 16 FN, 16 GN, 16 DN with scale reading

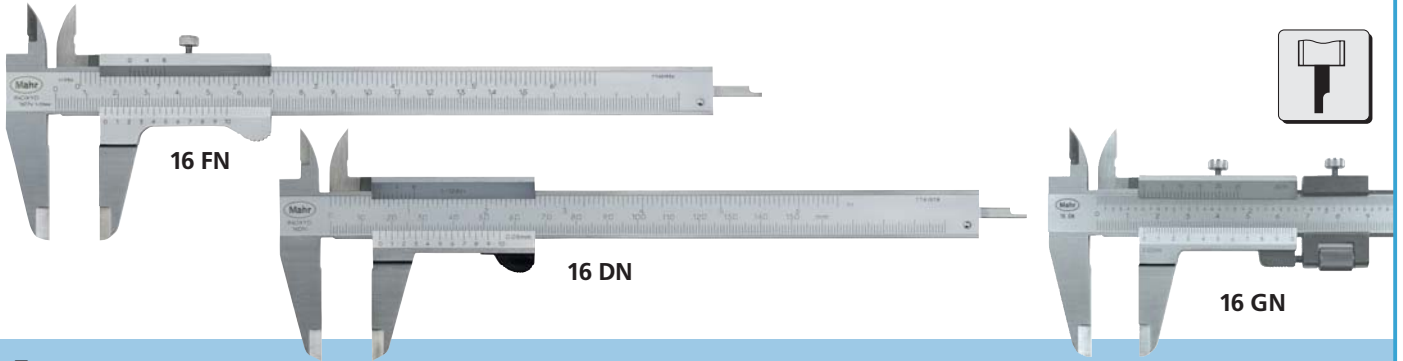

Features

- Vernier and main scale have a satin chrome finish for glare free reading
- Slide and beam made of hardened stainless steel
- Raised guide ways for the protection of the scale
- Measuring blades for inside measurement
- Step measuring function
- Depth bar
- Locking screw or thumb clamp
- Scope of supply: Plastic case and thread table

Technical Data

	Measuring range mm (inch)	Readings		Error limit G		Order no. without fine adjustment	Order no. with fine adjustment	Remarks
		upper inch	lower mm	mm/inch	DIN 862			
16 FN	150			0.05	0.05	4100420		Locking screw above
16 FN	150 (6")	1/128"	0.05	0.05/.002"	●	4100400		
16 DN	150 (6")	1/128"	0.05	0.05/.002"	●	4100600		Thumb clamp
16 N	150 (6")	1/128"	0.05	0.05/.002"	●	4100500		
16 GN	150		0.02	0.04		4100650	4100660*	Locking screw below
16 GN	150 (6")	.001"	0.02	0.04/.0016"		4100670	4100680*	
16 FN	200			0.05	0.05	4100421		Locking screw above
16 FN	200 (8")	1/128"	0.05	0.05/.002"	●	4100401		
16 GN	200		0.02	0.05		4100651	4100661*	
16 GN	200 (8")	.001"	0.02	0.05/.002"		4100671	4100681*	
16 FN	300			0.05	0.05	4100422		Locking screw above
16 FN	300 (12")	1/128"	0.05	0.05/.002"	●	4100402		
16 GN	300		0.02	0.05		4100652	4100662*	
16 GN	300 (12")	.001"	0.02	0.05/.002"		4100672	4100682*	

* Calipers with fine adjustment the measuring range is shortened by 20 mm / 1"

Dimensions

mm/inch	a	b	c	d	e	f
150/ 6	10/4	40/1.5	16/6	228/9	16 x 3/ .6 x .12	3.8/150
200/ 8	14/5	50/2.0	19/7.5	290/11	17 x 3.5/ .6 x .14	3.8/150
300/ 12	16/6	64/2.5	23.9	404/16	20 x 4/ .8 x .15	4.8/189

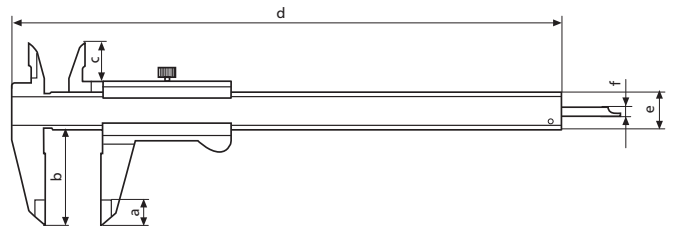

Accessories

	Order no.
Depth Measuring Bridge	16 Em 4102020
Leather case for meas. range 150 mm	4100302

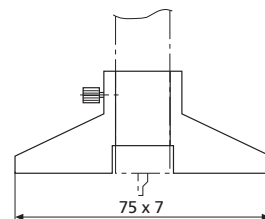

16 Em